

Housing	Shaft Dia	A	B	C	D	E	F	G	H
SAF 511D	1 15/16	9 5/8	2 3/4	15/16	2 3/4	3 3/4	5 1/4	7 5/8	2-bolt
SAF 513D	2 3/16	11	3 1/8	1	3	4 1/4	5 15/16	8 11/16	2-bolt
SAF 515D	2 7/16	11 1/4	3 1/8	1 1/8	3 1/4	4 5/8	6 3/8	9 1/8	1 7/8
SAF 517D	2 15/16	13	3 1/2	1 1/4	3 3/4	4 13/16	7 5/16	10 7/16	2 1/8
SAF 520D	3 7/16	15 1/4	4 3/8	1 3/4	4 1/2	5 13/16	8 3/4	12 3/8	2 3/8
SAF 522D	3 15/16	16 1/2	4 3/4	2	4 15/16	6 7/16	9 5/8	13 9/16	2 3/4
SAF 526D	4 7/16	18 3/8	5 1/8	2 3/8	6	7 3/4	11 1/2	15 5/16	3 1/4
SAF 528D	4 15/16	20 1/8	5 7/8	2 3/8	6	7 3/8	11 3/4	16 9/16	3 3/8
SAF 532D	5 7/16	22	6 1/4	2 5/8	6 11/16	8 1/2	13 5/16	18 5/16	3 3/4
SAF 534D	5 15/16	24 3/4	6 3/4	2 3/4	7 1/16	9 1/4	14 3/16	20 1/2	4 1/4
SAF 536D	6 7/16	26 3/4	7 1/8	3	7 1/2	9 5/8	14 7/8	22 1/4	4 5/8
SAF 538D	6 15/16	28	7 1/2	3 1/8	7 7/8	10 1/2	15 11/16	23	4 1/2
SAF 544D	7 15/16	32 3/4	8 3/4	3 3/4	9 1/2	11 3/4	18 5/8	26 5/16	5 1/4

### FEATURES AND BENEFITS

- SAFD housings are available in 2 or 4 bolt mounting up to 3 7/16" shaft sizes
- Bearing housings are made from spherical graphite iron (ductile iron – FCD450) which is stronger and more durable than standard cast iron
- Bearing assemblies come complete with housing, bearing, fixing rings, adaptor sleeve, seals and end cap to allow for open and closed shaft position as well as fixed and floating bearing set ups
- Bearings come standard with Labyrinth seals; Taconite seals optional
- Bearings meet or exceed industry standards for load capacities

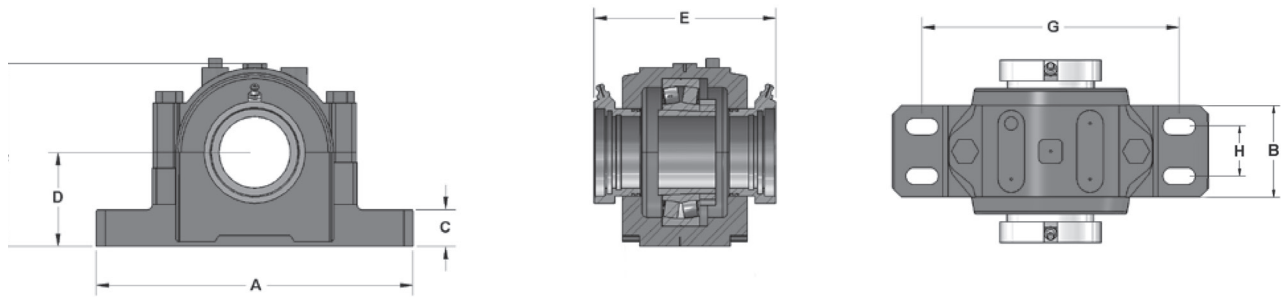

Housing	Shaft Dia	A	B	C	D	E	F	G	H
SAF 511D	1 15/16	9 5/8	2 3/4	15/16	2 3/4	6 5/16	5 1/4	7 5/8	2-bolt
SAF 513D	2 3/16	11	3 1/8	1	3	6 15/16	5 15/16	8 11/16	2-bolt
SAF 515D	2 7/16	11 1/4	3 1/8	1 1/8	3 1/4	7 5/16	6 3/8	9 1/8	1 7/8
SAF 517D	2 15/16	13	3 1/2	1 1/4	3 3/4	7 3/8	7 5/16	10 7/16	2 1/8
SAF 520D	3 7/16	15 1/4	4 3/8	1 3/4	4 1/2	8 3/4	8 3/4	12 3/8	2 3/8
SAF 522D	3 15/16	16 1/2	4 3/4	2	4 15/16	9 1/8	9 5/8	13 9/16	2 3/4
SAF 526D	4 7/16	18 3/8	5 1/8	2 3/8	6	10 7/16	11 1/2	15 5/16	3 1/4
SAF 528D	4 15/16	20 1/8	5 7/8	2 3/8	6	10 1/16	11 3/4	16 9/16	3 3/8
SAF 532D	5 7/16	22	6 1/4	2 5/8	6 11/16	11 3/16	13 5/16	18 5/16	3 3/4
SAF 534D	5 15/16	24 3/4	6 3/4	2 3/4	7 1/16	11 15/16	14 3/16	20 1/2	4 1/4
SAF 536D	6 7/16	26 3/4	7 1/8	3	7 1/2	12 5/16	14 7/8	22 1/4	4 5/8
SAF 538D	6 15/16	28	7 1/2	3 1/8	7 7/8	13 3/16	15 11/16	23	4 1/2
SAF 544D	7 15/16	32 3/4	8 3/4	3 3/4	9 1/2	14 7/16	18 5/8	26 5/16	5 1/4

### FEATURES AND BENEFITS

- SAFD housings are available in 2 or 4 bolt mounting up to 3 7/16" shaft sizes
- Bearing housings are made from spherical graphite iron (ductile iron – FCD450) which is stronger and more durable than standard cast iron
- Bearing assemblies come complete with housing, bearing, fixing rings, adaptor sleeve, seals and end cap to allow for open and closed shaft position as well as fixed and floating bearing set ups
- Bearings come standard with Labyrinth seals; Taconite seals optional
- Bearings meet or exceed industry standards for load capacities



www.ppi-global.com | sales@ppi-global.com

Product shown are for illustrative purposes only and may display optional accessories or components. Please contact your sales representative for more information on product specifications. PPI respectively reserves the right to make changes in engineering, design and specifications; add improvements; or discontinue manufacturing at any time without notice obligation. PPI and its respective logos are trademarks of Precision, Inc. in the US and or other countries.