

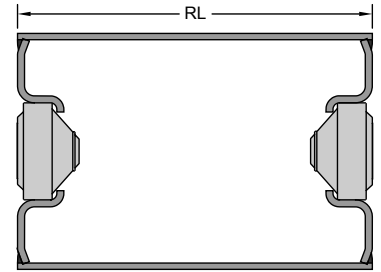

PPI provides the Marco Idler product line along with CB504 replacement rolls for stub shafts, bearings and rubber discs.

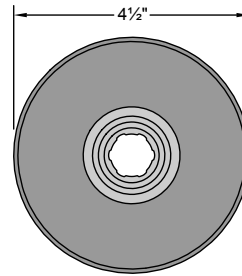

| PART # | ROLL LENGTH | WT | PART # | ROLL LENGTH | WT | PART # | ROLL LENGTH | WT |
|------------|-------------|-----|------------|-------------|------|------------|-------------|------|
| 3504-3 | 3 | 3.1 | 3504-17.5 | 17 1/2 | 9.9 | 3504-32.5 | 32 1/2 | 17 |
| 3504-4 | 4 | 3.6 | 3504-18.25 | 18 1/4 | 10.3 | 3504-33 | 33 | 17.2 |
| 3504-5 | 5 | 4.1 | 3504-18.5 | 18 1/2 | 10.4 | 3504-33.25 | 33 1/4 | 17.3 |
| 3504-5.5 | 5 1/2 | 4.4 | 3504-19.5 | 19 1/2 | 10.9 | 3504-33.5 | 33 1/2 | 17.4 |
| 3504-6 | 6 | 4.6 | 3504-20 | 20 | 11.1 | 3504-34 | 34 | 17.7 |
| 3504-6.5 | 6 1/2 | 4.8 | 3504-20.5 | 20 1/2 | 11.4 | 3504-34.25 | 34 1/4 | 17.8 |
| 3504-6.75 | 6 3/4 | 4.9 | 3504-20.75 | 20 3/4 | 11.5 | 3504-34.5 | 34 1/2 | 17.9 |
| 3504-7.5 | 7 1/2 | 5.2 | 3504-21 | 21 | 11.6 | 3504-35 | 35 | 18.1 |
| 3504-7.63 | 7 5/8 | 5.3 | 3504-22 | 22 | 12 | 3504-35.5 | 35 1/2 | 18.4 |
| 3504-8 | 8 | 5.5 | 3504-22.5 | 22 1/2 | 12.3 | 3504-36 | 36 | 18.6 |
| 3504-8.5 | 8 1/2 | 5.7 | 3504-23 | 23 | 12.5 | 3504-36.5 | 36 1/2 | 18.9 |
| 3504-8.75 | 8 3/4 | 5.9 | 3504-23.75 | 23 3/4 | 12.9 | 3504-37.5 | 37 1/2 | 19.3 |
| 3504-9 | 9 | 6 | 3504-24 | 24 | 13 | 3504-38 | 38 | 19.5 |
| 3504-9.25 | 9 1/4 | 6.1 | 3504-24.25 | 24 1/4 | 13.1 | 3504-38.5 | 38 1/2 | 19.8 |
| 3504-9.5 | 9 1/2 | 6.2 | 3504-24.5 | 24 1/2 | 13.2 | 3504-39 | 39 | 20 |
| 3504-9.75 | 9 3/4 | 6.3 | 3504-25.5 | 25 1/2 | 13.7 | 3504-39.25 | 39 1/4 | 20.1 |
| 3504-10 | 10 | 6.4 | 3504-25.75 | 25 3/4 | 13.8 | 3504-40 | 40 | 20.5 |
| 3504-10.25 | 10 1/4 | 6.6 | 3504-26 | 26 | 13.9 | 3504-40.5 | 40 1/2 | 20.7 |
| 3504-10.5 | 10 1/2 | 6.7 | 3504-26.25 | 26 1/4 | 14 | 3504-41 | 41 | 20.9 |
| 3504-11 | 11 | 6.9 | 3504-26.5 | 26 1/2 | 14.1 | 3504-43 | 43 | 21.9 |
| 3504-11.5 | 11 1/2 | 7.1 | 3504-26.75 | 26 3/4 | 14.3 | 3504-44 | 44 | 22.4 |
| 3504-12 | 12 | 7.4 | 3504-27 | 27 | 14.4 | 3504-45 | 45 | 22.8 |
| 3504-12.25 | 12 1/4 | 7.5 | 3504-27.75 | 27 3/4 | 14.7 | 3504-45.5 | 45 1/2 | 23 |
| 3504-12.5 | 12 1/2 | 7.6 | 3504-28 | 28 | 14.9 | 3504-46 | 46 | 23.3 |
| 3504-12.75 | 12 3/4 | 7.7 | 3504-28.25 | 28 1/4 | 15 | 3504-46.5 | 46 1/2 | 23.5 |
| 3504-13 | 13 | 7.8 | 3504-28.5 | 28 1/2 | 15.1 | 3504-49.88 | 49 7/8 | 25.1 |
| 3504-14 | 14 | 8.5 | 3504-28.75 | 28 3/4 | 15.2 | 3504-50 | 50 | 25.2 |
| 3504-14.5 | 14 1/2 | 8.6 | 3504-29 | 29 | 15.3 | 3504-50.25 | 50 1/4 | 25.3 |
| 3504-15 | 15 | 8.8 | 3504-29.75 | 29 3/4 | 15.7 | 3504-51.25 | 51 1/4 | 25.8 |
| 3504-15.5 | 15 1/2 | 9 | 3504-30.5 | 30 1/2 | 16 | 3504-52.5 | 52 1/2 | 26.3 |
| 3504-15.75 | 15 3/4 | 9.1 | 3504-31 | 31 | 16.3 | 3504-54.75 | 54 3/4 | 27.4 |
| 3504-16.25 | 16 1/4 | 9.4 | 3504-31.5 | 31 1/2 | 16.5 | 3504-56 | 56 | 28.2 |
| 3504-16.5 | 16 1/2 | 9.5 | 3504-32 | 32 | 16.7 | 3504-60 | 60 | 29.9 |
| 3504-17 | 17 | 9.7 | 3504-32.13 | 32 1/8 | 16.8 | 3504-63 | 63 | 31.3 |

| CB504 STUB SHAFTS | | | | | |
|-------------------|-------------------|------|---------|--------|------|
| PART # | DESCRIPTION | TYPE | A | B | WT |
| 40450 | End Stub Shaft | I | 1 15/16 | 15/16 | 0.21 |
| 40451 | End Stub Shaft | I | 2 1/2 | 1 1/2 | 0.30 |
| 40452 | End Stub Shaft | I | 3 | 2 | 0.37 |
| 40453 | End Stub Shaft | III | 1 15/16 | 13/16 | 0.19 |
| 40455 | Center Stub Shaft | II | 2 5/8 | 3/8 | 0.24 |
| 40456 | Center Stub Shaft | II | 2 5/8 | 5/8 | 0.26 |
| 40458 | Center Stub Shaft | II | 3 | 1 | 0.34 |
| 40460 | Center Stub Shaft | II | 3 3/32 | 3/8 | 0.28 |
| 40461 | Center Stub Shaft | II | 3 3/32 | 1 3/32 | 0.36 |
| 40462 | Center Stub Shaft | II | 3 9/16 | 3/8 | 0.33 |

Standard End Stub Shaft - Type I

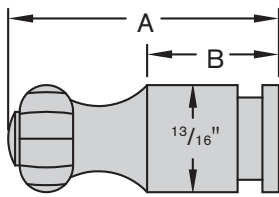

Standard Center Stub Shaft - Type II

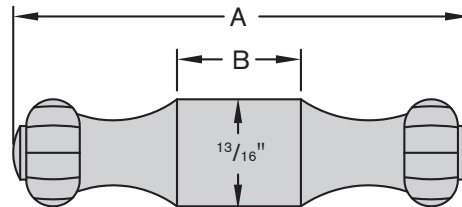

Special End Stub Shaft - Type III

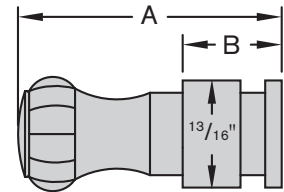

www.ppi-global.com | sales@ppi-global.com

Product shown are for illustrative purposes only and may display optional accessories or components. Please contact your sales representative for more information on product specifications. PPI respectively reserves the right to make changes in engineering, design and specifications; add improvements; or discontinue manufacturing at any time without notice obligation. PPI and its respective logos are trademarks of Precision, Inc. in the US and or other countries. Marco® is a registered trademark of Continental Manufacturing Co.